

New generation of vertical fuse switches NH00 size



Optimal safety



Smart fuse switch

Includes the option of advanced supervision



160 A

Current rating
For 185 mm busbars



New ergonomic design

Three pole disconnection (DT) and one pole disconnection (DU) for better handling



Increased robustness

With AC-23B



Responsible plastic use reduction



Revised single pole switching with fix handle and one pole disconnection

FEATURES

New handle design with increased robustness for improved single pole opening.

AC-23B category.

▶ RANGE

Reference	Type	Depth	Switching	Handle	Connections	Fuse-link	Busbar spacing
443.51.10.XX.YY	Vertical design fuse switches	00	One pole	Fixed	Top/Bottom reversible	NH00	185 mm
443.51.12.XX.YY		02					

New triple pole fuse switches with one or two handle and three pole disconnection

FEATURES

Increased robustness for a better handling.

AC-23B category.

▶ RANGE

Reference	Type	Handle	Depth	Switching	Connections	Fuse-link	Busbar spacing
443.91.10.XX.YY	Vertical design fuse switches	One handle	00	Three pole	Top/Bottom reversible	NH00	185 mm
443.91.12.XX.YY			02				
443.61.10.XX.YY		Two handles	00				
443.61.12.XX.YY			02				

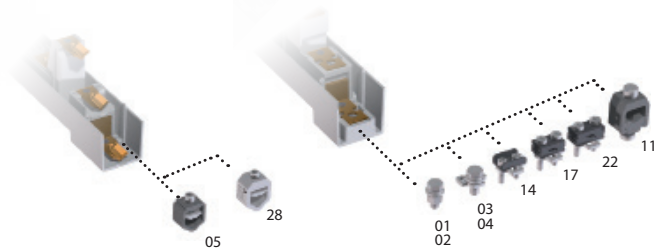

▶ TERMINALS

Code	Reference	Type of terminal	Torque (Nm)	Cross section (mm ²)			
				10-70	6-70	35-70	50-70
01	-	M8 screw A2/M8	12	 Cable lugs DIN 46235 Max 120 mm ²			
02	-	M8 screw Zn/M8	12				
03*	-	M8 screw A2+M5 (15 mm)	12				
04**	-	M8 screw A2+M5/M8 (18 mm)	12				
14	-	Bridge clamp	2,5	10-70	6-70	35-70	50-70
17	-	Prism terminal-70	2,5	10-70	10-70	35-70	50-70
22	-	Prism terminal-95	2,5	10-95	10-95	35-95	50-95
11	-	Screwed "V" Terminal	15	10-95	16-120	35-120	50-150
28	101.01.122	Aluminum "V" Terminal	15	10-95	10-95	25-120	25-150
05	101.01.114	Steel "V" Terminal	15	10-70	10-70	25-95	20-120

* Compatible with Prism terminal-70 and Bridge clamp.

** Compatible with Prism terminal-95.

Consult our Smart Grids solution for this fuse switches range here.

▶ VERTICAL FUSE SWITCH NH00 ONE POLE DISCONNECTION

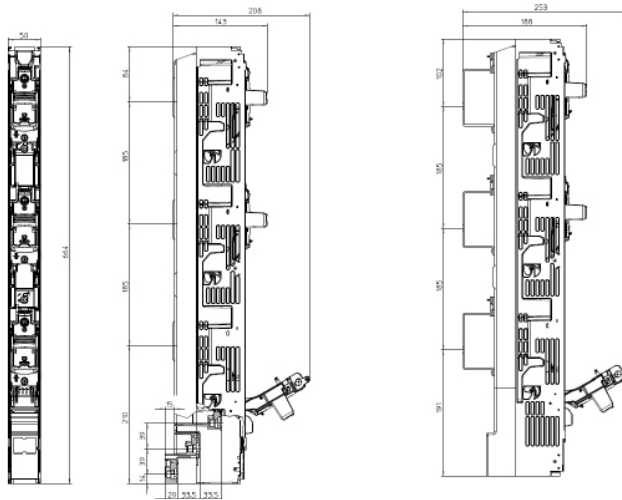

▶ VERTICAL FUSE SWITCH NH00 THREE POLE DISCONNECTION - COMPACT HANDLE

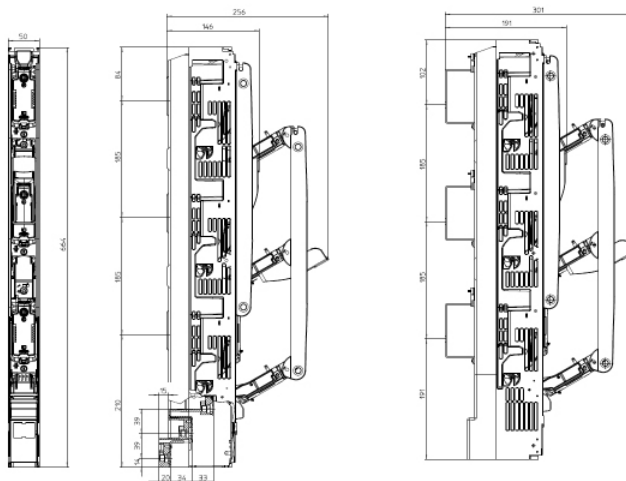

▶ VERTICAL FUSE SWITCH NH00 THREE POLE DISCONNECTION - TWO HANDLES

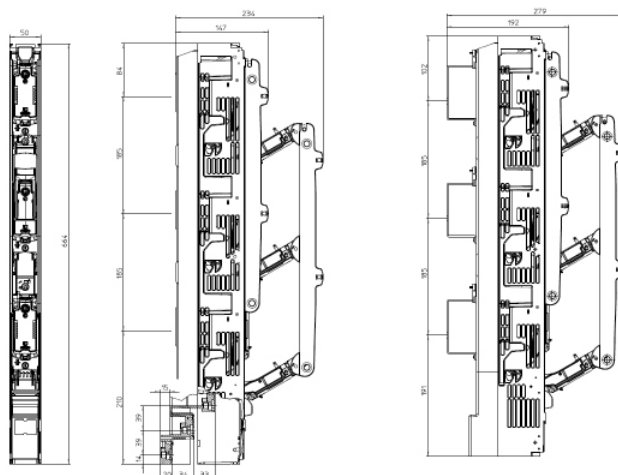

► TECHNICAL DATA

IEC/EN 6094		Type	BTVC/BTVC-DT 185 mm		
Technical data	Rated operational voltage	U_e (V)	AC 400	AC 500	AC 690
	Rated operational current	I_e (A)	160	160	160
	Conventional free air thermal current with fuses	I_{th} (A)	160	160	160
	Conventional free air thermal current with solid links	I_{th} (A)	20		
	Rated frequency	Hz	50		
	Rated insulation voltage	U_i (V)	1000		
	Rated conditional short-circuit current	(kA_{eff})	120		
	Utilization category		AC-23B	AC-22B	
	Rated making capacity	A	1600	480	480
	Rated breaking capacity	A	1280	480	480
	Rated impulse withstand voltage	U_{imp} (kV)	12		
	Operating cycles with current		200	200	200
	Total power loss at I_{th} (without fuse)	P_v (W)	22	22	22
	Panel front opening	mm	600/650		
	Operating cycles without current		1400	1400	1700
Fuse links	Size to IEC/EN 60269		NH 00 - NH 000		
	Max. rated current (gL/gG)	I_n (A)	160	160	160
	Max. permis. power loss per fuse-link	P_v (W)	12	12	12
Protection degree	Front operated switchgear fitted		IP30 / Closed IP20 / Open		

Protection Equipment for LV Distribution Networks

Specialists since 1986 in the design and manufacturing of solutions for protection, distribution and monitoring of low voltage electrical networks, we are presents in more than 70 countries.

We are focused on promoting the smartization and digitalization of the electrical networks of the future through new solutions and services that respond to the challenges of the market. More than 2400 companies trust in our solutions.

Our products range:

- Vertical and horizontal design fuse switches
- Low Voltage distribution panels
- Monitoring systems for Low Voltage networks
- AC/DC Solutions for photovoltaic applications
- Medium and Low Voltage fuses